



Big universe for
little kids...







SOUTH INDIA'S LEADING REAL ESTATE COMPANY

Casagrand Builder Private Limited is a real estate enterprise committed to building aspirations and delivering value. In the last seventeen years, we have developed over 30 million sq.ft of prime residential real estate across Chennai, Bengaluru and Coimbatore. Over 22,000 happy families across 125+ landmark properties stand testimony to our commitment.

In the seventeen years of our journey, we at Casagrand are all set to progress further forward with projects worth over ₹8000 crores in the pipeline.

Big universe for little kids...



A universe for the little explorer. Yes, that's what Casagrand Hazen is all about. A kids-centric community designed with the little geniuses of your family in mind. We have put together the best amenities to give them an unforgettable childhood.

With over 100+ amenities, 60 exclusively for kids, Casagrand Hazen is the right place for your kid to explore and learn in the most fun way possible. Each amenity is aptly designed giving importance to the kids' physical and cognitive growth. The amenities are built with top safety features and puts your kids comfort and safety first.



ENTRY VIEW



Bannerghatta's Finest Homes



The lifestyle at Hazen is one of exclusivity and privilege. Modern day conveniences are deftly weaved into your home and the community as a whole to give unparalleled experiences.

Every home employs clever use of space, light, functionality and aesthetics to impart an aura of warmth and joy. Coupled with this are the world-class lifestyle amenities that make living at Hazen a perpetual joy.

Beautifully crafted 622 finest 1,2, 3 & 4 BHK apartments on 9 acres along Bannerghatta road at Gottigere

1. Exclusive Kids-themed Community to enhance the overall development of the Children
2. The project is designed with basement car parks & vehicle-free podiums making it safe for kids and senior citizens
3. 100+ world-class amenities & features like swimming pool, 3D Home theater, Meditation Deck, Squash Court, interactive gym, Amphitheater & many more
4. 25,000 sq.ft. Grand Clubhouse with plenty of indoor & terrace amenities
5. Thoughtfully designed master and unit plans with a major focus on 5 important design elements like light, ventilation, privacy, beautiful views & Vaastu.
6. 3-acre landscaped areas for ample light, ventilation & recreational activities
7. 60+ exclusive Kid's amenities like Bowling alley, Play walk fun zone, Maze garden, Swing lawn, Augmented Rock climbing wall & many more
8. Carefully chosen high-end specifications like Digital Door Lock, Mobile Charging Dock, Premium brand sanitary fittings & many more
9. 100% Vaastu Compliant Homes designed with no wastage of spaces.
10. Luxurious exteriors like the Grand Entrance arch & entry lobby and 5-Star interiors in the Clubhouse give a Lavish feel to the community

ELEVATION VIEW





AERIAL VIEW





100+ FUN AMENITIES FOR ALL



ENTERTAINMENT

- 1 Multipurpose party hall
- 2 3D home theatre
- 3 Business centre
- 4 Guest entertainment lounge
- 5 Guest room
- 6 Salon and spa
- 7 Café counter

HEALTH AND FITNESS

- 8 Gym
- 9 Interactive gym
- 10 Crossfit corner
- 11 Boxing corner
- 12 Weightlifting
- 13 Yoga
- 14 Aerobics / Dance floor
- 15 Sauna
- 16 Steam
- 17 Jacuzzi

KIDS FUN AND RECREATION

- 18 Virtual reality games
- 19 Interactive wall and floor games
- 20 Augmented rock climbing wall
- 21 Gaming arcade
- 22 Hookey ring toss
- 23 Ball pool
- 24 Magnetic wall games

INDOOR GAMES

- 25 Badminton court
- 26 Squash court
- 27 Table tennis
- 28 Snooker
- 29 Board games
- 30 Foosball
- 31 Dart wall
- 32 Video games

KIDS LEARNING AND DEVELOPMENT

- 33 Learning centre
- 34 Day care centre
- 35 Kids waiting lounge
- 36 Art and craft corner
- 37 Short story vending machine
- 38 Clipping board

FACILITIES

- 39 Association room
- 40 Convenience store
- 41 Laundry / Ironing shop
- 42 Electric car charging bay
- 43 Car wash bay
- 44 Air filling station
- 45 Drivers / Househelp dormitory
- 46 Drivers / Househelp toilet

SWIMMING POOL AMENITIES

- 47 Swimming Pool
- 48 Pool side barbeque
- 49 Kids pool
- 50 Water play jets
- 51 Pool-side lounges

KIDS OUTDOOR AMENITIES

- 52 Multi-purpose sports court
- 53 Basketball practise court for kids
- 54 Skating / Mini hockey rink
- 55 Kids drop-off zone
- 56 Bicycle racks with bicycles
- 57 Play walk fun zone
- 58 Outdoor kids hobby zone
- 59 Cricket net
- 60 Bowling alley
- 61 Bobble ride for kids
- 62 Rock climbing wall
- 63 Jungle gym
- 64 Science park
- 65 Kids congregation corner
- 66 Cycling track
- 67 Tree house
- 68 Sand pit
- 69 Pet park
- 70 Hammock zone
- 71 Tree court
- 72 Trampoline
- 73 Swing lawn
- 74 Hopscotch

- 75 Giant chess
- 76 Sensory play area
- 77 Obstacle arena
- 78 Giant snake & ladder
- 79 Kids running track
- 80 Cognitive play area
- 81 Hedge maze garden

OUTDOOR AMENITIES

- 82 Amphitheatre
- 83 Spill-over party lawn with staging deck
- 84 Barbeque corner
- 85 Walking / jogging track
- 86 Meditation deck
- 87 Reflexology walkway
- 88 Sports viewing gallery
- 89 Senior citizens seating area
- 90 Outdoor gym
- 91 Outdoor movie screening wall
- 92 Outdoor yoga
- 93 100m race track
- 94 Butterfly park
- 95 Leisure seating bays
- 96 Outdoor performing stage
- 97 Nanny's pavilion
- 98 Putting golf
- 99 Silent seating zone
- 100 Aroma garden
- 101 DIY organic garden
- 102 Zen garden



HOME THEATRE

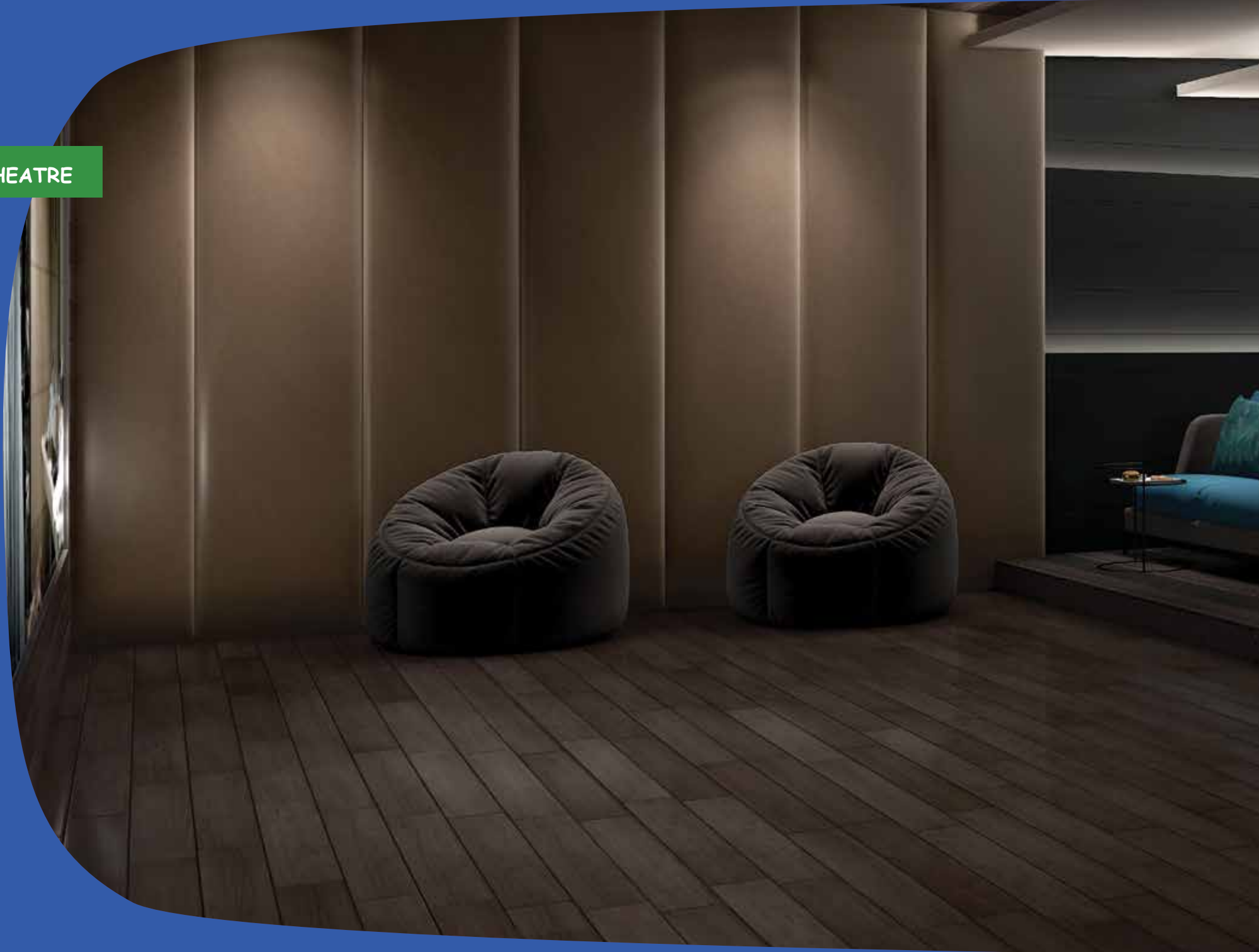



CLUBHOUSE







A Community for Kids

Casagrand Hazen is a Kids theme community with specially designed amenities for children to explore, learn and discover their true passions.

- Kid's Learning and development- is given utmost importance in Casagrand Hazen. Amenities like Learning center and Arts & craft corner combine fun with learning.
- Kid's Safety and security- App based visitor management system along with live streaming at Kids play areas ensure kids safety within the community.
- Kid's Fun and recreation- Casagrand Hazen has a world of amenities so your child can have an active lifestyle with excellent games and sports facilities.
- Kid's Convenience- features like day care center and kids waiting lounge provided in the community for the convenience of kids
- Kid's friendly Homes- Right from Digital door lock to kids friendly handrails, safety of kids is ensured in every homes

A Premium community for a Superlative Life

- Premium community design – Finely crafted community set amidst 9 acres of area planned with central podiums and vast green spaces.
- 24x7 security- Controlled entry and exit in the project facilitated with CCTV surveillance at pivotal points ensures 24x7 security.
- Grand Entry – The community is greeted with a grand Entrance Archway beautified with lighting create an inviting appeal into the community.
- Contemporary facade - Modern elevation with façade lighting uplift the building exteriors and landscape creating interest in the community.
- 3 acres of landscaped area – sprawled with amenities and multiple entertainment for kids of all age groups.
- Kids & Senior citizen friendly community - Meticulous planning has been done to ensure the community is a Kids & Senior citizen friendly community.

100+ Lifestyle Amenities

- 100+ Amenities of outdoor and indoor recreational facilities are sprawled across the project enhancing the social environment and liveliness of the community.
- Dedicated club house of 25,000 sft with world-class amenities and features.
- 5star Club House- Club house meticulously designed with 5 star interiors
- Guest room with guest entertainment Lounge to keep the guests accommodated during their visits
- 3D Home Theater – AV room equipped with 3D projector for a 3D movie watching experience.
- Exclusive Gym- with top notch features like crossfit corner, interactive gym and Dance floor take work out to next level
- Spa and Jacuzzi in the community for a relaxed evening
- Exclusive kids amenities- 60% of the amenities are designed for the entertainment of the kids in the community
- Kids' friendly amenities - Apart from general amenities like kids play area, sports court, the community has unique kids friendly amenities like rock climbing wall, chalk board wall which instill social interaction among the kids.
- Kids waiting lounge allows kids to spend their time wisely after school while both their parents are at work.
- Fun and recreational amenities like virtual reality games, interactive wall game and magnetic wall to keep the child engaged in an array of activities.
- Outdoor Movie watching experience - party lawn with projector screen facility is planned such that, the residents can spend time outdoors during matches.
- Open to sky rooftop swimming pool is arguably the ultimate in luxury added with features like waterfall and spa pool pathway adding to the entertainment.
- Kids pool with Fountain and floor jet features give the kids an experience of a theme park within the community.
- Activities for every age group – The amenities are planned for the healthy lifestyle of residents of all age groups.
- Senior citizen friendly amenities like reflexology walkway, leisure seating for the old age group.

- Organic farming - A dedicated space is provided to encourage farming and gardening within the community by allowing them to cultivate their vegetables and fruits by their own self.
- Way to healthy life - Outdoor fitness amenities like Outdoor gym, multipurpose sports court, and Kids gym encourages residents of all age groups to spend couple of minutes for their healthy life.
- Electric charging station for the comfort of charging your e-vehicles.
- Car wash station and Air filling station give the comfort of servicing your vehicle inside the community.
- Maid Rooms are located at the stilt level for maids and Driver's who reside in the community
- Access to daily needs - Convenience store and Ironing shop provided for the ease of daily provisional hassles.

The best of Homes

- Spacious Planning of homes with bigger sized bedrooms, toilets of minimum size 8'x5' and dedicated utility area
- Grand main door with designer architrave and signage creating a welcoming effect to your home
- Digital lock for main door - New generation digital lock system with which you can unlock your door with a simple touch and can even remotely monitor the lock status and share the digital key to any visitors.
- Mobile charging station enables wireless phone charging comfort at easy reach
- 7'ht sliding windows offer 3 times more light , ventilation and beautiful views
- Premium Bathroom Specification- Counter top washbasin and rain shower for all the bathrooms with Premium brand bathroom fittings
- Ensuring beautiful views- All homes are planned in such a way that they either look outside or internal podiums making every bedroom and balcony enjoying good view and ventilation.
- No overlooking Units - All Bedroom windows and balconies are planned in a manner to ensure you the podium or outside view with no overlooking into another apartment

- Vaastu compliant- Conscious efforts have been taken during design phase to have most of the units Vaastu compliant by achieving the following
 - All apartments have North and East facing entry
 - Most of the kitchen are Northwest or Southeast Kitchen.
 - No apartments have toilets in SW or NE
 - Bedroom in South west corner.
 - North facing headboards are avoided
 - No units have NE/ SW toilets and kitchen
- Zero dead space - Internal and external spaces have been designed with zero space wastage, giving you maximum usable area in your apartment
- No units facing each other - To ensure more privacy and security, units have been designed in such a way that the entrance doors do not face each other.
- Lighting and ventilation - All windows, OTS, cutouts, shafts ensure ventilation not only within your apartment but also in the corridors.
- Planned ODU locations - designed to avoid any overlooking or hindrances to other apartments and well concealed to ensure no AC's are visible on the building façade.



SITE PLAN



GROUND FLOOR PLAN

INDOOR AMENITIES

- 1 Multipurpose Party hall
- 2 3D Home Theatre
- 3 Business centre
- 4 Guest entertainment lounge
- 5 Guest Room
- 6 Salon and spa
- 7 Café counter
- 8 Gym
- 9 Interactive Gym
- 10 Cross fit Corner
- 11 Boxing corner
- 12 Weightlifting
- 13 Yoga
- 14 Aerobics / Dance floor
- 15 Sauna
- 16 Steam
- 17 Jacuzzi
- 18 Virtual reality games
- 19 Interactive wall and floor games
- 20 Augmented Rock climbing wall
- 21 Gaming Arcade
- 22 Hookey ring toss
- 23 Ball pool
- 24 Magnetic wall games
- 25 Badminton court
- 26 Squash Court
- 27 Table tennis
- 28 Snooker
- 29 Board games
- 30 Foosball





OUTDOOR AMENITIES

- | | | | |
|----|---|-----|------------------------------|
| 52 | Multi-purpose sports court | 84 | Barbeque corner |
| 53 | Basket ball practise court for kids | 85 | Walking / jogging track |
| 54 | Skating / Mini hockey rink | 86 | Meditation deck |
| 55 | Kids drop off zone | 87 | Reflexology walkway |
| 56 | Bicycle racks with bicycles | 88 | Sports Viewing Gallery |
| 57 | Play walk fun zone | 89 | Senior citizens seating area |
| 58 | Outdoor kids hobby zone | 90 | Outdoor gym |
| 59 | Cricket net | 91 | Outdoor Movie screening wall |
| 60 | Bowling Alley | 92 | Outdoor Yoga |
| 61 | Bobble ride for kids | 93 | 100m Race track |
| 62 | Rock climbing wall | 94 | Butterfly park |
| 63 | Jungle gym | 95 | Leisure seating Bays |
| 64 | Science park | 96 | Outdoor performing stage |
| 65 | Kids congregation corner | 97 | Nanny's pavilion |
| 66 | Cycling track | 98 | Putting Golf |
| 67 | Tree house | 99 | Silent seating zone |
| 68 | Sand pit | 100 | Aroma garden |
| 69 | Pet park | 101 | DIY Organic garden |
| 70 | Hammock zone | 102 | Zen garden |
| 71 | Tree court | | |
| 72 | Trampoline | | |
| 73 | Swing lawn | | |
| 74 | Hop scotch | | |
| 75 | Giant chess | | |
| 76 | Sensory play area | | |
| 77 | Obstacle arena | | |
| 78 | Giant Snake & Ladder | | |
| 79 | Kids running track | | |
| 80 | Cognitive play area | | |
| 81 | Hedge Maze garden | | |
| 82 | Amphitheatre | | |
| 83 | Spill over party lawn with staging deck | | |
| 31 | Dart wall | | |
| 32 | Video game | | |
| 33 | Learning Centre | | |
| 34 | Day care centre | | |
| 35 | Kids waiting lounge | | |
| 36 | Art and craft corner | | |
| 37 | Short story vending machine | | |
| 38 | Clipping board | | |
| 39 | Association room | | |
| 40 | Convenience store | | |
| 41 | Laundry / Ironing shop | | |
| 42 | Electric Car charging Bay | | |
| 43 | Car wash Bay | | |
| 44 | Air filling station | | |
| 45 | Drivers/ Maid dormitory | | |
| 46 | Drivers/ Maid Toilet | | |
| 47 | Swimming Pool | | |
| 48 | Pool side Barbeque | | |
| 49 | Kids Pool | | |
| 50 | Water play jets | | |
| 51 | Pool side lounges | | |

ENTRANCE LOBBY



FLOOR PLAN



BASEMENT FLOORPLAN

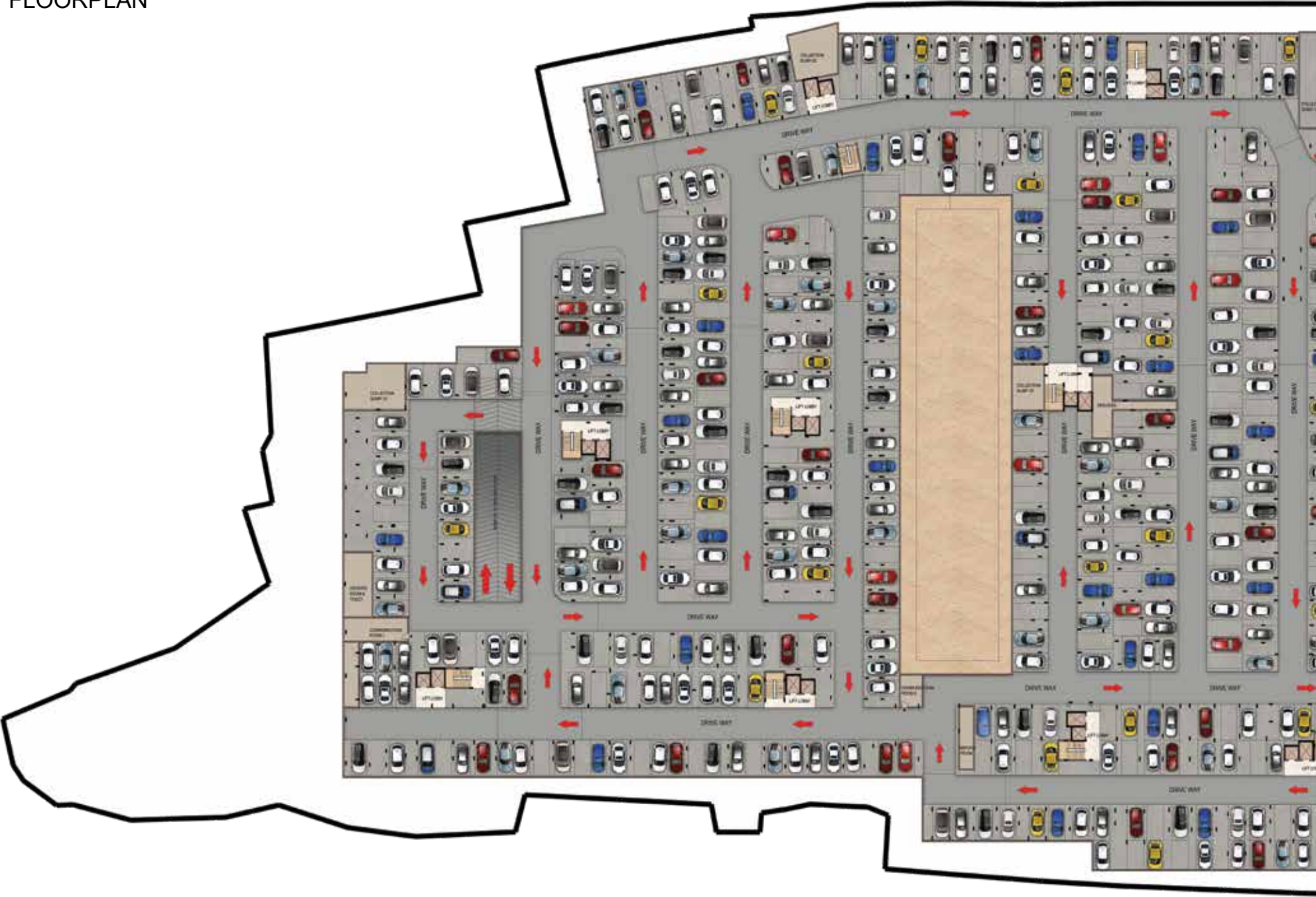

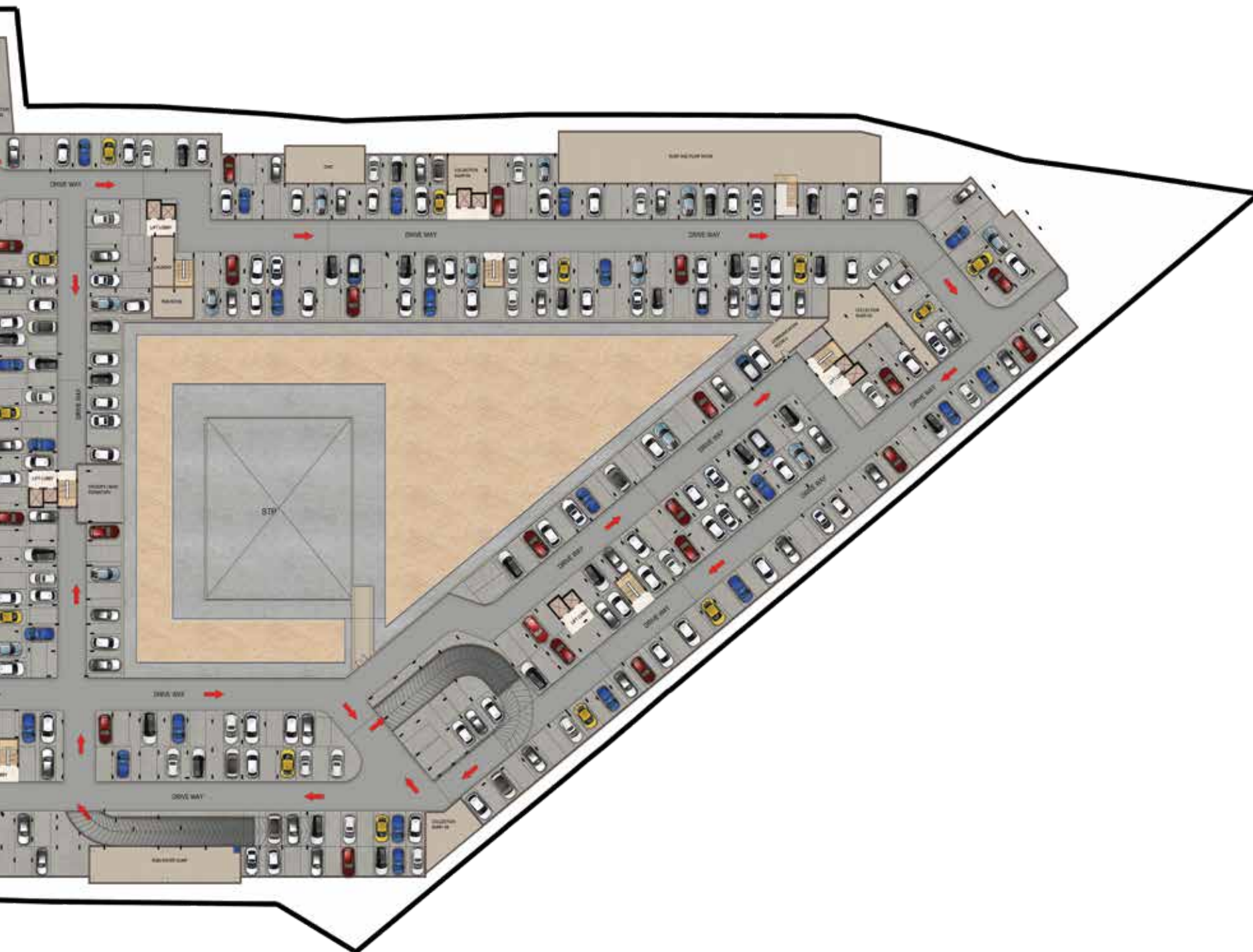
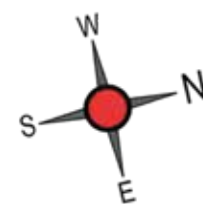

FIRST FLOOR PLAN

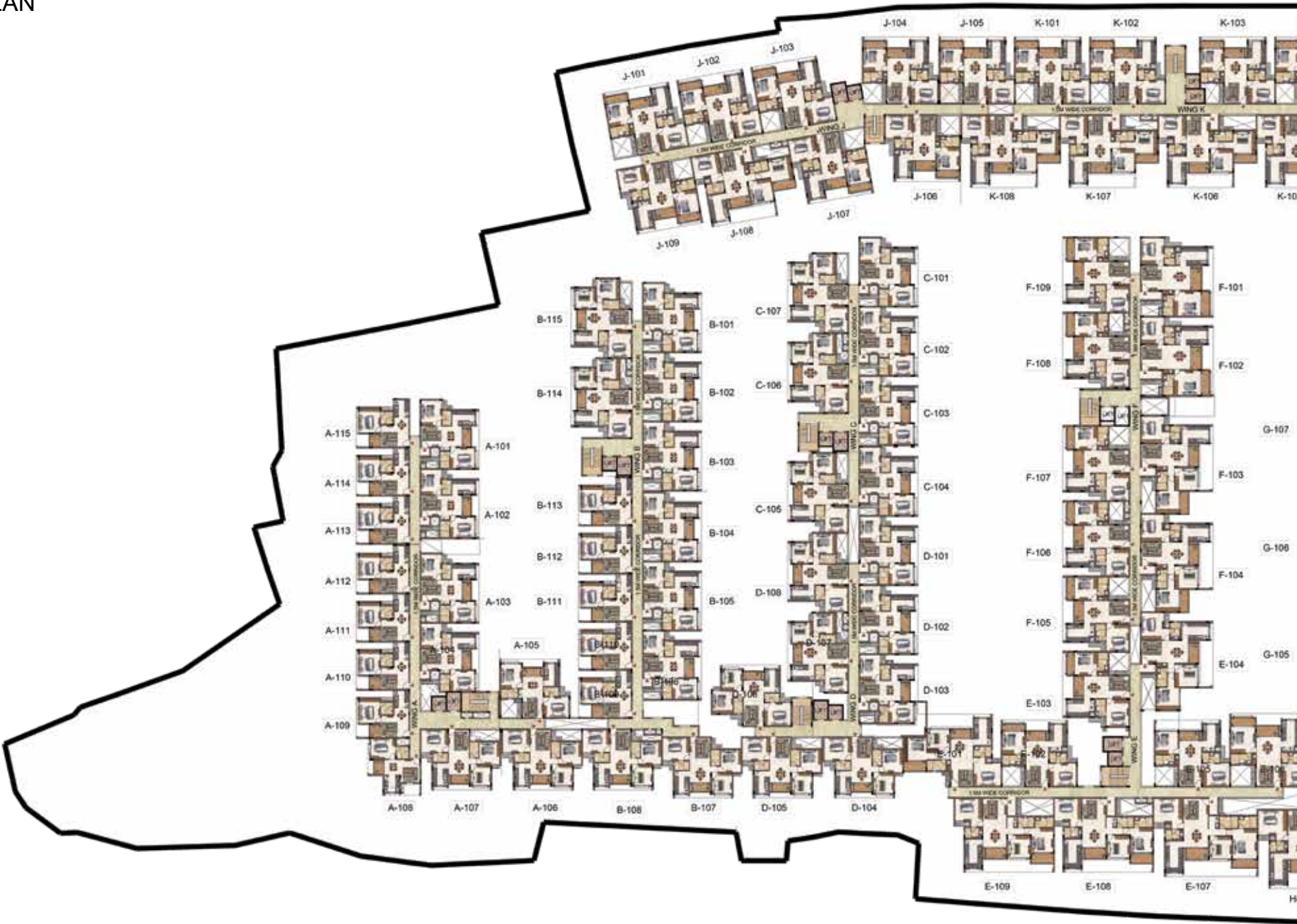



TYPICAL FLOOR PLAN





INDOOR KIDS PLAY AREA



UNIT PLAN



1BHK-1T- A 108 - A 408 & DG05
 3BHK-2T- A G06 - A 406
 B G07 - B 407
 B G08 - B 408
 D G04 - D 404
 D 105 - D 405

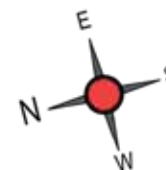

UNIT NO - D G05 GROUND FLOOR



TYPICAL FLOOR



UNIT NO - A 108 - A 408 TYPICAL FLOOR

| UNIT NO. | APARTMENT TYPE | CARPET AREA (SQ.FT) | BALCONY AREA (SQ.FT) | TOTAL CARPET AREA (SQ.FT) | SALEABLE AREA (SQ.FT) | PRIVATE TERRACE (SQ.FT) |
|---------------|----------------|---------------------|----------------------|---------------------------|-----------------------|-------------------------|
| A G06 - A 406 | 3BHK - 2T | 767 | 35 | 802 | 1156 | - |
| A G07 - A 407 | 3BHK - 2T | 767 | 35 | 802 | 1155 | - |
| A 108 - A 408 | 1BHK - 1T | 402 | 31 | 433 | 621 | - |
| B G07 - B 407 | 3BHK - 2T | 767 | 35 | 802 | 1150 | - |
| B G08 - B 408 | 3BHK - 2T | 767 | 35 | 802 | 1148 | - |
| D G04 | 3BHK - 2T | 767 | 35 | 802 | 1156 | - |
| D 104 - D 404 | 3BHK - 2T | 767 | 35 | 802 | 1152 | - |
| D G05 | 1BHK - 1T | 494 | 35 | 529 | 758 | - |
| D 105 - D 405 | 3BHK - 2T | 767 | 35 | 802 | 1152 | - |



KEY PLAN

1BHK-1T- A G09 - A 409, A G10 - A 410, A G11 - A 411, A G12 - A 412
 A G13 - A 413, A G14 - A 414, A G15 - A 415
 B G09 - B 409, B G10 - B 410, B G11 - B 411, B G12 - B 412
 B G13 - B 413

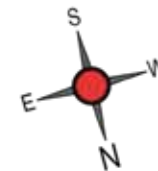

UNIT NO - A G09, A G10, A G11, GROUND FLOOR
 A G12, A G13, A G14,
 A G15
 B G09, B G10, B G11,
 B G12, B G13



UNIT NO -
 A 109 - A 409, A 110 - A 410
 A 111 - A 411, A 112 - A 412
 A 113 - A 413, A 114 - A 414
 A 115 - A 415
 B 109 - B 409, B 110 - B 410
 B 111 - B 411, B 112 - B 412
 B 113 - B 413

TYPICAL FLOOR

| UNIT NO. | APARTMENT TYPE | CARPET AREA (SQ.FT) | BALCONY AREA (SQ.FT) | TOTAL CARPET AREA (SQ.FT) | SALEABLE AREA (SQ.FT) | PRIVATE TERRACE (SQ.FT) |
|--------------------------------|----------------|---------------------|----------------------|---------------------------|-----------------------|-------------------------|
| A G09, A G10 | 1BHK - 1T | 402 | 33 | 435 | 633, 630 | 33, 37 |
| A 109 - A 409 A 110 - A 410 | 1BHK - 1T | 402 | 33 | 435 | 628, 630 | - |
| A G11, A G12 | 1BHK - 1T | 402 | 33 | 435 | 630, 633 | 37 |
| A 111 - A 411 A 112 - A 412 | 1BHK - 1T | 402 | 33 | 435 | 630, 633 | - |
| A G13, A G14 | 1BHK - 1T | 402 | 33 | 435 | 633, 630 | 37 |
| A 113 - A 413 A 114 - A 414 | 1BHK - 1T | 402 | 33 | 435 | 633, 630 | - |
| A G15, B G09 | 1BHK - 1T | 402 | 33 | 435 | 633, 633 | 37 |
| A 115 - A 415 B 109 - B 409 | 1BHK - 1T | 402 | 33 | 435 | 633, 633 | - |
| B G10, B G11 | 1BHK - 1T | 402 | 33 | 435 | 630, 630 | 37 |
| B 110 - B 410 B 111 - B 411 | 1BHK - 1T | 402 | 33 | 435 | 630, 630 | - |
| B G12, B G13 | 1BHK - 1T | 402 | 33 | 435 | 630, 633 | 37 |
| B 112 - B 412 B 113 - B 413 | 1BHK - 1T | 402 | 33 | 435 | 630, 633 | - |



KEY PLAN

1BHK-1T- BG03, CG03
 2BHK-2T- B G01 - B 401, B G02 - B 402
 B 103 - B 403, B G04 - B 404
 B G05 - B 405, B G06 - B 406
 C G01 - C 401, C G02 - C 402
 C 103 - C 403, C G04 - C 404

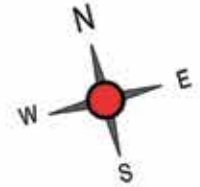

UNIT NO - B G03
 C G03
 GROUND FLOOR



UNIT NO -
 B G01 - B 401, B G02 - B 402
 B 103 - B 403, B G04 - B 404
 B G05 - B 405, B G06 - B 406
 C G01 - C 401, C G02 - C 402
 C 103 - C 403, C G04 - C 404
 TYPICAL FLOOR

| UNIT NO. | APARTMENT TYPE | CARPET AREA (SQ.FT) | BALCONY AREA (SQ.FT) | TOTAL CARPET AREA (SQ.FT) | SALEABLE AREA (SQ.FT) | PRIVATE TERRACE (SQ.FT) |
|---------------|----------------|---------------------|----------------------|---------------------------|-----------------------|-------------------------|
| B G01 - B 401 | 2BHK - 2T | 646 | 35 | 681 | 999 | - |
| B G02 - B 402 | 2BHK - 2T | 646 | 35 | 681 | 997 | - |
| B G03 | 1BHK - 1T | 452 | 35 | 487 | 703 | - |
| B 103 - B 403 | 2BHK - 2T | 646 | 35 | 681 | 998 | - |
| B G04 - B 404 | 2BHK - 2T | 646 | 35 | 681 | 999 | - |
| B G05 - B 405 | 2BHK - 2T | 646 | 35 | 681 | 997 | - |
| B G06 - B 406 | 2BHK - 2T | 646 | 35 | 681 | 998 | - |
| C G01 - C 401 | 2BHK - 2T | 646 | 35 | 681 | 999 | - |
| C G02 - C 402 | 2BHK - 2T | 646 | 35 | 681 | 997 | - |
| C G03 | 1BHK - 1T | 452 | 35 | 487 | 703 | - |
| C 103 - C 403 | 2BHK - 2T | 646 | 35 | 681 | 998 | - |
| C G04 | 2BHK - 2T | 646 | 35 | 681 | 998 | - |
| C 104 - C 404 | 2BHK - 2T | 646 | 35 | 681 | 999 | - |



KEY PLAN

1BHK-1T

STUDY - DG03

2BHK-2T- A G01 - A 401, A G02 - A 402

A G03 - A 403, A G04 - A 404

D G01 - D 401, D G02 - D 402

D 103 - D 403

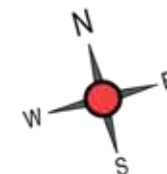

UNIT NO - D G03

GROUND FLOOR



UNIT NO -

A G01 - A 401, A G02 - A 402

A G03 - A 403, A G04 - A 404

D G01 - D 401, D G02 - D 402

D 103 - D 403

TYPICAL FLOOR

| UNIT NO. | APARTMENT TYPE | CARPET AREA (SQ.FT) | BALCONY AREA (SQ.FT) | TOTAL CARPET AREA (SQ.FT) | SALEABLE AREA (SQ.FT) | PRIVATE TERRACE (SQ.FT) |
|---------------|----------------|---------------------|----------------------|---------------------------|-----------------------|-------------------------|
| A G01 - A 401 | 2BHK - 2T | 646 | 35 | 681 | 999 | - |
| A G02 - A 402 | 2BHK - 2T | 646 | 35 | 681 | 998 | - |
| A G03 | 2BHK - 2T | 646 | 35 | 681 | 998 | - |
| A 103 - A 403 | 2BHK - 2T | 646 | 35 | 681 | 999 | - |
| A G04 - A 404 | 2BHK - 2T | 646 | 35 | 681 | 998 | - |
| D G01- D 401 | 2BHK - 2T | 646 | 35 | 681 | 997 | - |
| D G02 - D 402 | 2BHK - 2T | 646 | 35 | 681 | 997 | - |
| D G03 | 1BHK - 1T | 558 | 35 | 593 | 879 | - |
| D 103 - D 403 | 2BHK - 2T | 646 | 35 | 681 | 998 | - |



KEY PLAN

2BHK-2T- A G05 - A 405
3BHK-2T- D G06 - A 406

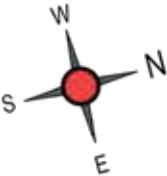

UNIT NO - A G05 - A 405 TYPICAL FLOOR



UNIT NO - D G06 - D 406 TYPICAL FLOOR

| UNIT NO. | APARTMENT TYPE | CARPET AREA (SQ.FT) | BALCONY AREA (SQ.FT) | TOTAL CARPET AREA (SQ.FT) | SALEABLE AREA (SQ.FT) | PRIVATE TERRACE (SQ.FT) |
|---------------|----------------|---------------------|----------------------|---------------------------|-----------------------|-------------------------|
| A G05 - A 405 | 2BHK - 2T | 628 | 35 | 663 | 970 | - |
| D G06 | 3BHK - 2T | 767 | 35 | 802 | 1155 | - |
| D 106 - D 406 | 3BHK - 2T | 767 | 35 | 802 | 1157 | - |



KEY PLAN

1BHK-1T
 STUDY- E G05
 2BHK-2T- E105 - E405



UNIT NO - E G05

GROUND FLOOR



UNIT NO - E 105 - E 405

TYPICAL FLOOR

| UNIT NO. | APARTMENT TYPE | CARPET AREA (SQ.FT) | BALCONY AREA (SQ.FT) | TOTAL CARPET AREA (SQ.FT) | SALEABLE AREA (SQ.FT) | PRIVATE TERRACE (SQ.FT) |
|---------------|----------------|---------------------|----------------------|---------------------------|-----------------------|-------------------------|
| E G05 | 1BHK - 1T | 647 | 44 | 691 | 1008 | 46 |
| E 105 - E 405 | 2BHK - 2T | 741 | 44 | 785 | 1134 | - |



KEY PLAN

1BHK-1T

STUDY - K G04

2BHK-2T- E G02 - E 402

K G01 - K 401

K G02 - K 402

K G03 - K 403

K 104 - K 404

J G04 - J 404

J G05 - J 405



UNIT NO - K G04

GROUND FLOOR



UNIT NO -

TYPICAL FLOOR

E 102 - E 402, K 101 - K 401

K 102 - K 402, K 103 - K 403

K 104 - K 404, J 104 - J 404

J 105 - J 405



UNIT NO - E G02, K G01, K G02

GROUND FLOOR

K G03, J G04

J G05

| UNIT NO | APARTMENT TYPE | CARPET AREA (SQ.FT) | BALCONY AREA (SQ.FT) | TOTAL CARPET AREA (SQ.FT) | SALEABLE AREA (SQ.FT) | PRIVATE TERRACE (SQ.FT) |
|---------------|----------------|---------------------|----------------------|---------------------------|-----------------------|-------------------------|
| E G02 | 2BHK - 2T | 746 | 82 | 828 | 1190 | 39 |
| E 102 - E 402 | 2BHK - 2T | 746 | 82 | 828 | 1190 | - |
| K G01, K G02 | 2BHK - 2T | 746 | 82 | 828 | 1188, 1189 | 39 |
| K 101 - K 401 | 2BHK - 2T | 746 | 82 | 828 | 1188, 1189 | - |
| K 102 - K 402 | 2BHK - 2T | 746 | 82 | 828 | 1188, 1189 | - |
| K G03 | 1BHK - 1T | 746 | 82 | 828 | 1189 | 39 |
| K 103 - K 403 | 2BHK - 2T | 746 | 82 | 828 | 1189 | - |
| K G04 | 1BHK - 1T | 619 | 82 | 701 | 1023 | 39 |
| K 104 - K 404 | 2BHK - 2T | 746 | 82 | 828 | 1190 | - |
| J G04, J G05 | 2BHK - 2T | 746 | 82 | 828 | 1191, 1189 | 39 |
| J 104 - A 404 | 2BHK - 2T | 746 | 82 | 828 | 1191, 1189 | - |
| J 105 - A 405 | 2BHK - 2T | 746 | 82 | 828 | 1191, 1189 | - |



KEY PLAN

1BHK-1T
 STUDY - J G09
 2BHK-2T- J G07 - J 407
 J 109 - J 409



UNIT NO - J 107 - J 407
 J 109 - J 409

TYPICAL FLOOR



UNIT NO - J G07

GROUND FLOOR



UNIT NO - J G09

GROUND FLOOR

| UNIT NO. | APARTMENT TYPE | CARPET AREA (SQ.FT) | BALCONY AREA (SQ.FT) | TOTAL CARPET AREA (SQ.FT) | SALEABLE AREA (SQ.FT) | PRIVATE TERRACE (SQ.FT) |
|---------------|----------------|---------------------|----------------------|---------------------------|-----------------------|-------------------------|
| J G07 | 2BHK - 2T | 746 | 82 | 828 | 1188 | 39 |
| J 107 - J 407 | 2BHK - 2T | 746 | 82 | 828 | 1188 | - |
| J G09 | 1BHK - 1T | 619 | 83 | 702 | 1024 | 40 |
| J 109 - J 409 | 2BHK - 2T | 746 | 82 | 828 | 1190 | - |



KEY PLAN

3BHK-2T- B G14 - B 414, B G15 - B 415
 C G05 - C 405, C G06 - C 406, C G07 - C 407
 D G07 - D 407, D G08 - D 408

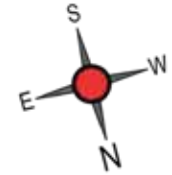

UNIT NO - B G14 - B 414
 B G15 - B 415
 C G05 - C 405
 C G06 - C 406

TYPICAL FLOOR



UNIT NO - C G07 - C 407
 D G07 - D 407
 D G08 - D 408

TYPICAL FLOOR

| UNIT NO. | APARTMENT TYPE | CARPET AREA (SQ.FT) | BALCONY AREA (SQ.FT) | TOTAL CARPET AREA (SQ.FT) | SALEABLE AREA (SQ.FT) | PRIVATE TERRACE (SQ.FT) |
|---------------|----------------|---------------------|----------------------|---------------------------|-----------------------|-------------------------|
| B G14 - B 414 | 3BHK - 2T | 767 | 35 | 802 | 1152 | - |
| B G15 - B 415 | 3BHK - 2T | 767 | 35 | 802 | 1154 | - |
| C G05 - C 405 | 3BHK - 2T | 767 | 35 | 802 | 1152 | - |
| C G06 - C 406 | 3BHK - 2T | 767 | 35 | 802 | 1152 | - |
| C G07 - C 407 | 3BHK - 2T | 767 | 35 | 802 | 1154 | - |
| D G07 - D 407 | 3BHK - 2T | 767 | 35 | 802 | 1154 | - |
| D G08 | 3BHK - 2T | 767 | 35 | 802 | 1150 | - |
| D 108 - D 408 | 3BHK - 2T | 767 | 35 | 802 | 1151 | - |



KEY PLAN

2BHK-2T- E G03 - E 403, F G05 - F 405
 F G06 - F 406, F G07 - F 407
 F G08 - F 408, F G09 - F 409

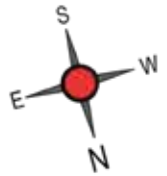

UNIT NO - E G03, F G05, F G06
 F G07, F G08, F G09

GROUND FLOOR



UNIT NO - E 103 - E 403
 F 105 - F 405
 F 106 - F 406
 F 107 - F 407
 F 108 - F 408
 F 109 - F 409

TYPICAL FLOOR

| UNIT NO. | APARTMENT TYPE | CARPET AREA (SQ.FT) | BALCONY AREA (SQ.FT) | TOTAL CARPET AREA (SQ.FT) | SALEABLE AREA (SQ.FT) | PRIVATE TERRACE (SQ.FT) |
|---------------|----------------|---------------------|----------------------|---------------------------|-----------------------|-------------------------|
| E G03 | 2BHK - 2T | 746 | 82 | 828 | 1190 | 39 |
| E 103 - E 403 | 2BHK - 2T | 746 | 82 | 828 | 1190 | - |
| F G05 | 2BHK - 2T | 746 | 82 | 828 | 1188 | 39 |
| F 105 - F 405 | 2BHK - 2T | 746 | 82 | 828 | 1188 | - |
| F G06 | 2BHK - 2T | 746 | 82 | 828 | 1188 | 39 |
| F 106 - F 406 | 2BHK - 2T | 746 | 82 | 828 | 1188 | - |
| F G07 | 2BHK - 2T | 746 | 82 | 828 | 1189 | 39 |
| F 107 - F 407 | 2BHK - 2T | 746 | 82 | 828 | 1189 | - |
| F G08 | 2BHK - 2T | 746 | 82 | 828 | 1190 | 39 |
| F 108 - F 408 | 2BHK - 2T | 746 | 82 | 828 | 1190 | - |
| F G09 | 2BHK - 2T | 746 | 82 | 828 | 1189 | 39 |
| F 109 - F 409 | 2BHK - 2T | 746 | 82 | 828 | 1190 | - |



KEY PLAN

2BHK-2T- J G01 - J 401
J G02 - J 402
J G03 - J 403



UNIT NO - J G01
J G02
J G03

GROUND FLOOR



UNIT NO - J 101 - J 401
J 102 - J 402
J 103 - J 403

TYPICAL FLOOR

| UNIT NO | APARTMENT TYPE | CARPET AREA (SQ.FT) | BALCONY AREA (SQ.FT) | TOTAL CARPET AREA (SQ.FT) | SALEABLE AREA (SQ.FT) | PRIVATE TERRACE (SQ.FT) |
|---------------|----------------|---------------------|----------------------|---------------------------|-----------------------|-------------------------|
| J G01 | 2BHK - 2T | 746 | 82 | 828 | 1189 | 41 |
| J 101 - J 401 | 2BHK - 2T | 746 | 82 | 828 | 1190 | - |
| J G02 | 2BHK - 2T | 746 | 82 | 828 | 1188 | 39 |
| J 102 - J 402 | 2BHK - 2T | 746 | 82 | 828 | 1188 | - |
| J G03 | 2BHK - 2T | 746 | 82 | 828 | 1189 | 39 |
| J 103 - J 403 | 2BHK - 2T | 746 | 82 | 828 | 1189 | - |



KEY PLAN

2BHK-2T- J G06 - J 406

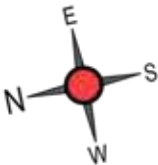

UNIT NO - J G06

GROUND FLOOR



UNIT NO - J 106 - J 406

TYPICAL FLOOR

| UNIT NO. | APARTMENT TYPE | CARPET AREA (SQ.FT) | BALCONY AREA (SQ.FT) | TOTAL CARPET AREA (SQ.FT) | SALEABLE AREA (SQ.FT) | PRIVATE TERRACE (SQ.FT) |
|---------------|----------------|---------------------|----------------------|---------------------------|-----------------------|-------------------------|
| J G06 | 2BHK - 2T | 746 | 82 | 828 | 1190 | 39 |
| J 106 - J 406 | 2BHK - 2T | 746 | 82 | 828 | 1190 | - |



KEY PLAN

1BHK-1T

STUDY- N G04

3BHK-3T- N G02 - N 402, N G03 - N 403, N 104 - N 404

P G03 - P 403

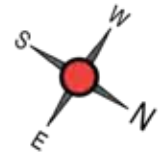

UNIT NO - N 104 - N 404

TYPICAL FLOOR



UNIT NO - N 102 - N 402, N 103 - N 403
P 103 - P 403

TYPICAL FLOOR



UNIT NO - N G04

ENTRY

GROUND FLOOR



UNIT NO - N G02, N G03
P G03

ENTRY

GROUND FLOOR

| UNIT NO. | APARTMENT TYPE | CARPET AREA (SQ.FT) | BALCONY AREA (SQ.FT) | TOTAL CARPET AREA (SQ.FT) | SALEABLE AREA (SQ.FT) | PRIVATE TERRACE (SQ.FT) |
|--------------------------------|----------------|---------------------|----------------------|---------------------------|-----------------------|-------------------------|
| N G02, N G03 | 2BHK - 2T | 853 | 102 | 955 | 1355, 1354 | 43 |
| N 102 - N 402 N 103 - N 403 | 2BHK - 2T | 853 | 102 | 955 | 1355, 1354 | - |
| N G04 | 1BHK - 1T | 727 | 102 | 829 | 1191 | 43 |
| N 104 - N 404 | 2BHK - 2T | 853 | 102 | 955 | 1357 | - |
| P G03 | 2BHK - 2T | 853 | 102 | 955 | 1351 | 43 |
| P 103 - P 403 | 2BHK - 2T | 853 | 102 | 955 | 1351 | - |



KEY PLAN

2BHK-2T- E G01
M G05
3BHK-2T- E 101 - E 401
M 105 - M405



UNIT NO - E G01

GROUND FLOOR



UNIT NO - E101 - E 401

TYPICAL FLOOR

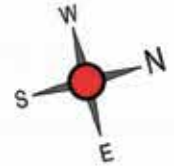

UNIT NO - M G05

GROUND FLOOR



UNIT NO - M105 - M 405

TYPICAL FLOOR

| UNIT NO. | APARTMENT TYPE | CARPET AREA (SQ.FT) | BALCONY AREA (SQ.FT) | TOTAL CARPET AREA (SQ.FT) | SALEABLE AREA (SQ.FT) | PRIVATE TERRACE (SQ.FT) |
|---------------|----------------|---------------------|----------------------|---------------------------|-----------------------|-------------------------|
| E G01 | 2BHK - 2T | 817 | 44 | 861 | 1229 | 137 |
| E 101 - E 401 | 3BHK - 2T | 946 | 96 | 1042 | 1471 | - |
| M G05 | 2BHK - 2T | 817 | 44 | 861 | 1231 | 141 |
| M 105 - M 405 | 3BHK - 2T | 946 | 90 | 1036 | 1463 | - |



KEY PLAN

2BHK-2T- E G04
 3BHK-2T- E104 - E404
 F 103 - F 403
 F 104 - F 404



UNIT NO - E 104 - E 404
 F 103 - F 403
 F 104 - F 404

TYPICAL FLOOR



UNIT NO - E G04

GROUND FLOOR



UNIT NO - F G03
 F G04

GROUND FLOOR

| UNIT NO. | APARTMENT TYPE | CARPET AREA (SQ.FT) | BALCONY AREA (SQ.FT) | TOTAL CARPET AREA (SQ.FT) | SALEABLE AREA (SQ.FT) | PRIVATE TERRACE (SQ.FT) |
|---------------|----------------|---------------------|----------------------|---------------------------|-----------------------|-------------------------|
| E G04 | 2BHK - 2T | 852 | 44 | 896 | 1271 | 141 |
| E 104 - E 404 | 3BHK - 2T | 976 | 44 | 1020 | 1446 | - |
| F G03 | 3BHK - 2T | 981 | 90 | 1071 | 1505 | 265 |
| F 103 - F 403 | 3BHK - 2T | 981 | 90 | 1071 | 1505 | - |
| F G04 | 3BHK - 2T | 981 | 90 | 1071 | 1503 | 265 |
| F 104 - F 404 | 3BHK - 2T | 981 | 90 | 1071 | 1503 | - |



KEY PLAN

2BHK-2T- K G05, KG08, MG06
 3BHK-2T- K 105 - K 405, K 108 - K 408
 M 106 - M 406

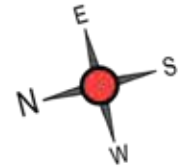

| UNIT NO. | APARTMENT TYPE | CARPET AREA (SQ.FT) | BALCONY AREA (SQ.FT) | TOTAL CARPET AREA (SQ.FT) | SALEABLE AREA (SQ.FT) | PRIVATE TERRACE (SQ.FT) |
|---------------|----------------|---------------------|----------------------|---------------------------|-----------------------|-------------------------|
| K G05 | 2BHK - 2T | 852 | 44 | 896 | 1274 | 170 |
| K 105 - K 405 | 3BHK - 2T | 976 | 44 | 1020 | 1449 | - |
| K G08 | 2BHK - 2T | 852 | 44 | 896 | 1275 | 141 |
| K 108 - K 408 | 3BHK - 2T | 981 | 90 | 1071 | 1506 | - |
| M G06 | 2BHK - 2T | 852 | 44 | 896 | 1274 | 141 |
| M 106 - K 406 | 3BHK - 2T | 981 | 90 | 1071 | 1508 | - |



2BHK-2T- H G01 - H 401

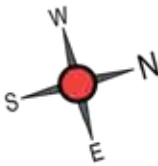

UNIT NO - H G01

GROUND FLOOR



UNIT NO - H 101 - H 401

TYPICAL FLOOR

| UNIT NO. | APARTMENT TYPE | CARPET AREA (SQ.FT) | BALCONY AREA (SQ.FT) | TOTAL CARPET AREA (SQ.FT) | SALEABLE AREA (SQ.FT) | PRIVATE TERRACE (SQ.FT) |
|---------------|----------------|---------------------|----------------------|---------------------------|-----------------------|-------------------------|
| H G01 | 2BHK - 2T | 847 | 53 | 900 | 1283 | 262 |
| H 101 - H 401 | 2BHK - 2T | 847 | 53 | 900 | 1283 | - |



KEY PLAN

2BHK-2T- L G04
 3BHK-3T- L G03 - L 403
 L 104 - L 404

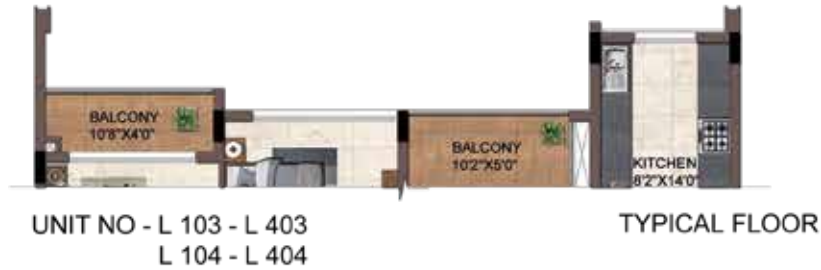

| UNIT NO. | APARTMENT TYPE | CARPET AREA (SQ.FT) | BALCONY AREA (SQ.FT) | TOTAL CARPET AREA (SQ.FT) | SALEABLE AREA (SQ.FT) | PRIVATE TERRACE (SQ.FT) |
|---------------|----------------|---------------------|----------------------|---------------------------|-----------------------|-------------------------|
| L G03 | 3BHK - 3T | 1052 | 94 | 1146 | 1612 | 179 |
| L 103 - L 403 | 3BHK - 3T | 1052 | 94 | 1146 | 1611 | - |
| L G04 | 2BHK - 2T | 861 | 51 | 912 | 1306 | - |
| L 104 - L 404 | 3BHK - 3T | 1052 | 94 | 1146 | 1613 | - |



2BHK-2T- F G01 - F 401, F G02 - F 402
G G03 - G 403

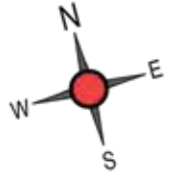

UNIT NO - F 101 - F 401
F 102 - F 402
G 103-G 403

TYPICAL FLOOR



UNIT NO - F G01
F G02

GROUND FLOOR



UNIT NO - G G03

GROUND FLOOR

| UNIT NO. | APARTMENT TYPE | CARPET AREA (SQ.FT) | BALCONY AREA (SQ.FT) | TOTAL CARPET AREA (SQ.FT) | SALEABLE AREA (SQ.FT) | PRIVATE TERRACE (SQ.FT) |
|---------------|----------------|---------------------|----------------------|---------------------------|-----------------------|-------------------------|
| F G01 | 2BHK - 2T | 902 | 102 | 1004 | 1418 | 43 |
| F 101 - F 401 | 2BHK - 2T | 902 | 102 | 1004 | 1418 | - |
| F G02 | 2BHK - 2T | 902 | 102 | 1004 | 1417 | 43 |
| F 102 - F 402 | 2BHK - 2T | 902 | 102 | 1004 | 1417 | - |
| G G03 | 2BHK - 2T | 868 | 53 | 921 | 1317 | - |
| G 103 - G 403 | 2BHK - 2T | 868 | 53 | 921 | 1317 | - |



KEY PLAN

2BHK-2T- G G04 - G 404
 3BHK-3T- G G05 - G 405, G G06 - G 406, G G07 - G 407



UNIT NO - G 104 - G 404

TYPICAL FLOOR



UNIT NO - G 105 - G 405, G 106 - G 406
 G 107 - G 407

TYPICAL FLOOR



UNIT NO - G G04

GROUND FLOOR



UNIT NO - G G05, G G06, G G07

GROUND FLOOR

| UNIT NO. | APARTMENT TYPE | CARPET AREA (SQ.FT) | BALCONY AREA (SQ.FT) | TOTAL CARPET AREA (SQ.FT) | SALEABLE AREA (SQ.FT) | PRIVATE TERRACE (SQ.FT) |
|---------------|----------------|---------------------|----------------------|---------------------------|-----------------------|-------------------------|
| G G04 | 2BHK - 2T | 853 | 102 | 955 | 1356 | 81 |
| G 104 - G 404 | 2BHK - 2T | 853 | 102 | 955 | 1356 | - |
| G G05 | 3BHK - 3T | 1169 | 107 | 1276 | 1785 | 205 |
| G 105 - G 405 | 3BHK - 3T | 1169 | 107 | 1276 | 1785 | - |
| G G06 | 3BHK - 3T | 1169 | 107 | 1276 | 1784 | 205 |
| G 106 - G 406 | 3BHK - 3T | 1169 | 107 | 1276 | 1784 | - |
| G G07 | 3BHK - 3T | 1169 | 107 | 1276 | 1790 | 205 |
| G 107 - G 407 | 3BHK - 3T | 1169 | 107 | 1276 | 1790 | - |



2BHK-2T- E G06 - E 406

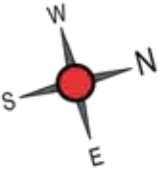

UNIT NO - E G06

GROUND FLOOR



UNIT NO - E 106 - E 406

TYPICAL FLOOR

| UNIT NO. | APARTMENT TYPE | CARPET AREA (SQ.FT) | BALCONY AREA (SQ.FT) | TOTAL CARPET AREA (SQ.FT) | SALEABLE AREA (SQ.FT) | PRIVATE TERRACE (SQ.FT) |
|---------------|----------------|---------------------|----------------------|---------------------------|-----------------------|-------------------------|
| E G06 | 2BHK - 2T | 853 | 102 | 955 | 1357 | 43 |
| E 106 - E 406 | 2BHK - 2T | 853 | 102 | 955 | 1357 | - |



KEY PLAN

3BHK-2T- L G01 - L 401
3BHK-3T- L G02 - L 402



UNIT NO - L 101 - L 401

TYPICAL FLOOR



UNIT NO - L 102 - L 402

TYPICAL FLOOR



UNIT NO - L G01

GROUND FLOOR



UNIT NO - L G02

GROUND FLOOR

| UNIT NO. | APARTMENT TYPE | CARPET AREA (SQ.FT) | BALCONY AREA (SQ.FT) | TOTAL CARPET AREA (SQ.FT) | SALEABLE AREA (SQ.FT) | PRIVATE TERRACE (SQ.FT) |
|---------------|----------------|---------------------|----------------------|---------------------------|-----------------------|-------------------------|
| L G01 | 3BHK - 2T | 942 | 44 | 986 | 1401 | 179 |
| L 101 - L 401 | 3BHK - 2T | 942 | 44 | 986 | 1401 | - |
| L G02 | 3BHK - 3T | 1052 | 94 | 1146 | 1613 | 179 |
| L 102 - L 402 | 3BHK - 3T | 1052 | 94 | 1146 | 1613 | - |



KEY PLAN

2BHK-2T- H G06
 3BHK-3T- E G07 - E 407
 H 103 - H 403, H G04 - H 404
 H G05 - H 405, H 106 - H 406
 L G08 - L 408



UNIT NO - E 107 - E 407, H 103 - H 403,
 H 104 - H 404, H 105 - H 405
 L 108 - L 408

TYPICAL FLOOR



UNIT NO - H G06

GROUND FLOOR



UNIT NO - E G07
 H G04, H G05
 L G08

GROUND FLOOR

| UNIT NO. | APARTMENT TYPE | CARPET AREA (SQ.FT) | BALCONY AREA (SQ.FT) | TOTAL CARPET AREA (SQ.FT) | SALEABLE AREA (SQ.FT) | PRIVATE TERRACE (SQ.FT) |
|---------------|----------------|---------------------|----------------------|---------------------------|-----------------------|-------------------------|
| E G07 | 3BHK - 3T | 1209 | 107 | 1316 | 1831 | 205 |
| E 107 - E 407 | 3BHK - 3T | 1209 | 107 | 1316 | 1831 | - |
| H 103 - H 403 | 3BHK - 3T | 1209 | 107 | 1316 | 1837 | - |
| H G04 | 3BHK - 3T | 1209 | 107 | 1316 | 1836 | 203 |
| H 104 - H 404 | 3BHK - 3T | 1209 | 107 | 1316 | 1834 | - |
| H G05 | 3BHK - 3T | 1209 | 107 | 1316 | 1837 | 205 |
| H 105 - H 405 | 3BHK - 3T | 1209 | 107 | 1316 | 1837 | - |
| H G06 | 2BHK - 2T | 947 | 59 | 1006 | 1422 | 205 |
| H 106 - H 406 | 3BHK - 3T | 1209 | 107 | 1316 | 1833 | - |
| L G08 | 3BHK - 3T | 1209 | 107 | 1316 | 1834 | 205 |
| L 108 - L 408 | 3BHK - 3T | 1209 | 107 | 1316 | 1834 | - |



KEY PLAN

3BHK-3T- GG01 - G401
GG02 - G402



UNIT NO - G 101 - G 401
G 102 - G 402

TYPICAL FLOOR



UNIT NO - G G01 & G G02

GROUND FLOOR

| UNIT NO. | APARTMENT TYPE | CARPET AREA (SQ.FT) | BALCONY AREA (SQ.FT) | TOTAL CARPET AREA (SQ.FT) | SALEABLE AREA (SQ.FT) | PRIVATE TERRACE (SQ.FT) |
|---------------|----------------|---------------------|----------------------|---------------------------|-----------------------|-------------------------|
| G G01 | 3BHK - 3T | 1293 | 150 | 1443 | 2043 | 157 |
| G G02 | 3BHK - 3T | 1293 | 147 | 1440 | 2038 | 234 |
| G 101 - G 401 | 3BHK - 3T | 1293 | 150 | 1443 | 2043 | - |
| G 102 - G 402 | 3BHK - 3T | 1293 | 147 | 1440 | 2038 | - |



3BHK-2T- K G06 - K 406
K G07 - K 407

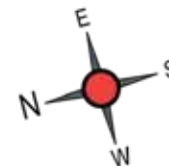

UNIT NO - K G06, K G07

GROUND FLOOR



UNIT NO - K 106 - K 406
K 107 - K 407

TYPICAL FLOOR

| UNIT NO. | APARTMENT TYPE | CARPET AREA (SQ.FT) | BALCONY AREA (SQ.FT) | TOTAL CARPET AREA (SQ.FT) | SALEABLE AREA (SQ.FT) | PRIVATE TERRACE (SQ.FT) |
|---------------|----------------|---------------------|----------------------|---------------------------|-----------------------|-------------------------|
| K G06 | 3BHK - 2T | 981 | 90 | 1071 | 1503 | 265 |
| K 106 - K 406 | 3BHK - 2T | 981 | 90 | 1071 | 1503 | - |
| K G07 | 3BHK - 2T | 981 | 90 | 1071 | 1505 | 265 |
| K 107 - K 407 | 3BHK - 2T | 981 | 90 | 1071 | 1503 | - |



KEY PLAN

3BHK-2T- J G08 - J 408

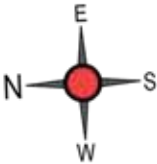

UNIT NO - J G08

GROUND FLOOR



UNIT NO - J 108

TYPICAL FLOOR

| UNIT NO. | APARTMENT TYPE | CARPET AREA (SQ.FT) | BALCONY AREA (SQ.FT) | TOTAL CARPET AREA (SQ.FT) | SALEABLE AREA (SQ.FT) | PRIVATE TERRACE (SQ.FT) |
|---------------|----------------|---------------------|----------------------|---------------------------|-----------------------|-------------------------|
| J G08 | 3BHK - 2T | 981 | 90 | 1071 | 1504 | 242 |
| J 108 - J 408 | 3BHK - 2T | 981 | 90 | 1071 | 1504 | - |



KEY PLAN

3BHK-2T- N G05 - N 405

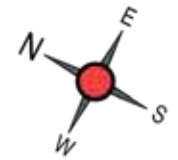

UNIT NO - N G05

GROUND FLOOR



UNIT NO - N 105 - N 405

TYPICAL FLOOR

| UNIT NO. | APARTMENT TYPE | CARPET AREA (SQ.FT) | BALCONY AREA (SQ.FT) | TOTAL CARPET AREA (SQ.FT) | SALEABLE AREA (SQ.FT) | PRIVATE TERRACE (SQ.FT) |
|---------------|----------------|---------------------|----------------------|---------------------------|-----------------------|-------------------------|
| N G05 | 3BHK - 2T | 981 | 90 | 1071 | 1508 | 141 |
| N 105 - N 405 | 3BHK - 2T | 981 | 90 | 1071 | 1508 | - |



KEY PLAN

3BHK-3T- M G01 - M 401
M G02 - M 402
M G03 - M 403
M G04 - M 404



UNIT NO - M G01, M G02
M G03, M G04

GROUND FLOOR



UNIT NO -
M 101 - M 401, M 102 - M 402
M 103 - M 403, M 104 - M 404

TYPICAL FLOOR

| UNIT NO. | APARTMENT TYPE | CARPET AREA (SQ.FT) | BALCONY AREA (SQ.FT) | TOTAL CARPET AREA (SQ.FT) | SALEABLE AREA (SQ.FT) | PRIVATE TERRACE (SQ.FT) |
|---------------|----------------|---------------------|----------------------|---------------------------|-----------------------|-------------------------|
| M G01 | 3BHK - 3T | 1052 | 94 | 1146 | 1612 | 179 |
| M 101 - M 401 | 3BHK - 3T | 1052 | 94 | 1146 | 1612 | - |
| M G02 | 3BHK - 3T | 1052 | 94 | 1146 | 1611 | 179 |
| M 102 - M 402 | 3BHK - 3T | 1052 | 94 | 1146 | 1611 | - |
| M G03 | 3BHK - 3T | 1052 | 94 | 1146 | 1610 | 179 |
| M 103 - M 403 | 3BHK - 3T | 1052 | 94 | 1146 | 1610 | - |
| M G04 | 3BHK - 3T | 1052 | 94 | 1146 | 1611 | 179 |
| M 104 - M 404 | 3BHK - 3T | 1052 | 94 | 1146 | 1609 | - |



KEY PLAN

3BHK-3T- N G06 - N 406, N G07 - N 407, N G08 - N 408
P G05 - P 405, P G06 - P 406, P 107 - P 407

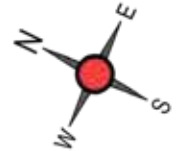

UNIT NO - N G06, N G07, N G08
P G05, P G06

GROUND FLOOR



UNIT NO -
N 106 - N 406, N 107 - N 407, N 108 - N 408
P 105 - P 405, P 106 - P 406, P 107 - P 407

TYPICAL FLOOR

| UNIT NO. | APARTMENT TYPE | CARPET AREA (SQ.FT) | BALCONY AREA (SQ.FT) | TOTAL CARPET AREA (SQ.FT) | SALEABLE AREA (SQ.FT) | PRIVATE TERRACE (SQ.FT) |
|--------------------------------|----------------|---------------------|----------------------|---------------------------|-----------------------|-------------------------|
| N G06, N G07 | 3BHK - 3T | 1093 | 104 | 1197 | 1676 | 167 |
| N 106 - N 406 N 107 - N 407 | 3BHK - 3T | 1093 | 104 | 1197 | 1676 | - |
| N G08, P G05 | 3BHK - 3T | 1093 | 104 | 1197 | 1678 | 167 |
| N 108 - N 408 P 105 - P 405 | 3BHK - 3T | 1093 | 104 | 1197 | 1678 | - |
| P G06 | 3BHK - 3T | 1093 | 104 | 1197 | 1677 | 167 |
| P 106 - P 406 P 107 - P 407 | 3BHK - 3T | 1093 | 104 | 1197 | 1677, 1678 | - |



KEY DI AN

3BHK-3T- E G08 - E 408, E G09 - E 409
 L G05 - L 405, L G06 - L 406
 M G07 - M 407, M G08 - M 408
 M G09 - M 409



UNIT NO - E G08, E G09
 L G05, L G06
 M G07, M G08, M G09

GROUND FLOOR



UNIT NO - E 108 - E 408, E 109 - E 409
 L 105 - L 405, L 106 - L 406
 M 107 - M 407, M 108 - M 408,
 M 109 - M 409

TYPICAL FLOOR

| UNIT NO. | APARTMENT TYPE | CARPET AREA (SQ.FT) | BALCONY AREA (SQ.FT) | TOTAL CARPET AREA (SQ.FT) | SALEABLE AREA (SQ.FT) | PRIVATE TERRACE (SQ.FT) |
|--------------------------------|----------------|---------------------|----------------------|---------------------------|-----------------------|-------------------------|
| E G08, E G09 | 3BHK - 3T | 1093 | 104 | 1197 | 1675, 1676 | 167 |
| E 108 - E 408 E 109 - E 409 | 3BHK - 3T | 1093 | 104 | 1197 | 1675, 1676 | - |
| L G05, L G06 | 3BHK - 3T | 1093 | 104 | 1197 | 1677 | 167 |
| L 105 - L 405 L 106 - L 406 | 3BHK - 3T | 1093 | 104 | 1197 | 1678, 1677 | - |
| M G07, M G08 | 3BHK - 3T | 1093 | 104 | 1197 | 1676, 1677 | 167 |
| M 107 - M 407 M 108 - M 408 | 3BHK - 3T | 1093 | 104 | 1197 | 1676, 1677 | - |
| M G09 | 3BHK - 3T | 1093 | 104 | 1197 | 1680 | 167 |
| M 109 - M 409 | 3BHK - 3T | 1093 | 104 | 1197 | 1680 | - |



KEY PLAN

2BHK-2T- P G01
4BHK-4T- P 101 - P 401

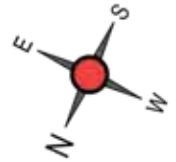

UNIT NO - P G01

GROUND FLOOR



UNIT NO - P 101- 401

TYPICAL FLOOR

| UNIT NO. | APARTMENT TYPE | CARPET AREA (SQ.FT) | BALCONY AREA (SQ.FT) | TOTAL CARPET AREA (SQ.FT) | SALEABLE AREA (SQ.FT) | PRIVATE TERRACE (SQ.FT) |
|---------------|----------------|---------------------|----------------------|---------------------------|-----------------------|-------------------------|
| P G01 | 2BHK - 2T | 1077 | 132 | 1209 | 1715 | 137 |
| P 101 - P 401 | 4BHK - 4T | 1552 | 163 | 1715 | 2425 | - |



KEY PLAN

3BHK-3T- NG01-N401

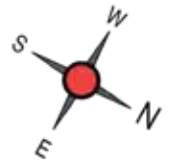

UNIT NO - N 101 - N 401

TYPICAL FLOOR



UNIT NO - N G01

GROUND FLOOR

| UNIT NO. | APARTMENT TYPE | CARPET AREA (SQ.FT) | BALCONY AREA (SQ.FT) | TOTAL CARPET AREA (SQ.FT) | SALEABLE AREA (SQ.FT) | PRIVATE TERRACE (SQ.FT) |
|---------------|----------------|---------------------|----------------------|---------------------------|-----------------------|-------------------------|
| N G01 | 3BHK - 3T | 1291 | 141 | 1432 | 2034 | 161 |
| N 101 - N 401 | 3BHK - 3T | 1292 | 141 | 1433 | 2034 | - |



3BHK-3T- LG07 - L407



UNIT NO - L 107 - L 407

TYPICAL FLOOR



UNIT NO - L G07

GROUND FLOOR

| UNIT NO. | APARTMENT TYPE | CARPET AREA (SQ.FT) | BALCONY AREA (SQ.FT) | TOTAL CARPET AREA (SQ.FT) | SALEABLE AREA (SQ.FT) | PRIVATE TERRACE (SQ.FT) |
|---------------|----------------|---------------------|----------------------|---------------------------|-----------------------|-------------------------|
| L G07 | 3BHK - 3T | 1293 | 147 | 1440 | 2038 | 83 |
| L 107 - L 407 | 3BHK - 3T | 1293 | 147 | 1440 | 2038 | - |



KEY PLAN

4BHK-4T- PG02 - P402
PG04 - P404

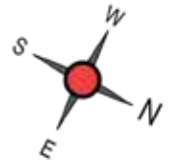

UNIT NO - P 102 - P 402
P 104 - P 404

TYPICAL FLOOR



UNIT NO - P G02 & P G04

GROUND FLOOR

| UNIT NO. | APARTMENT TYPE | CARPET AREA (SQ.FT) | BALCONY AREA (SQ.FT) | TOTAL CARPET AREA (SQ.FT) | SALEABLE AREA (SQ.FT) | PRIVATE TERRACE (SQ.FT) |
|---------------|----------------|---------------------|----------------------|---------------------------|-----------------------|-------------------------|
| P G02 | 4BHK - 4T | 1558 | 163 | 1721 | 2423 | 246 |
| P G04 | 4BHK - 4T | 1558 | 163 | 1721 | 2427 | 246 |
| P 102 - P 402 | 4BHK - 4T | 1558 | 163 | 1721 | 2423 | - |
| P 104 - P 404 | 4BHK - 4T | 1558 | 163 | 1721 | 2427 | - |



KEY PLAN

4BHK-4T- HG02 - H402



UNIT NO - H 102 - H 402

TYPICAL FLOOR



UNIT NO - H G02

GROUND FLOOR

| UNIT NO. | APARTMENT TYPE | CARPET AREA (SQ.FT) | BALCONY AREA (SQ.FT) | TOTAL CARPET AREA (SQ.FT) | SALEABLE AREA (SQ.FT) | PRIVATE TERRACE (SQ.FT) |
|---------------|----------------|---------------------|----------------------|---------------------------|-----------------------|-------------------------|
| H G02 | 4BHK - 4T | 1558 | 163 | 1721 | 2428 | 246 |
| H 102 - H 402 | 4BHK - 4T | 1558 | 163 | 1721 | 2428 | - |



KEY PLAN

CLUBHOUSE PLAN



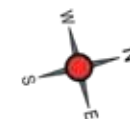

GROUND FLOOR PLAN



FIRST FLOOR PLAN

INDOOR AMENITIES

1. Multipurpose Party hall
3. Business centre
4. Guest entertainment lounge
5. Guest Room
7. Café counter
18. Virtual reality games
24. Magnetic wall games
25. Badminton court
26. Squash Court
27. Table tennis
28. Snooker
29. Board games
30. Foosball
31. Dart wall
32. Video Game
33. Learning Centre
36. Art & craft corner



KEY PLAN

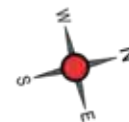

SECOND FLOOR



TERRACE FLOOR

INDOOR AMENITIES

2. 3D Home Theatre
6. Salon and spa
8. Gym
9. Interactive Gym
10. Cross fit Corner
11. Boxing corner
12. Weightlifting
13. Yoga
14. Aerobics / Dance floor
15. Sauna
16. Steam
17. Jacuzzi
19. Interactive wall and floor games
20. Augmented Rock climbing wall
21. Gaming Arcade
22. Hookey ring toss
23. Ball pool
34. Day care centre
35. Kids waiting lounge
37. Short story vending machine
38. Clipping board
39. Association room
47. Swimming Pool
48. Pool side Barbeque
49. Kids Pool
50. Water play jets
51. Pool side lounges



KEY PLAN

SPECIFICATIONS

1. STRUCTURE

Structural System : RCC Framed Structure designed for seismic compliant (Zone 2)

Masonry : 200mm for external walls & 100mm for internal walls

Floor - Floor height (incl. slab) : Will be maintained at 2950mm

ATT : Anti-termite treatment will be done

2. WALL / CEILING FINISH

Internal walls : Finished with 2 coats of putty, 1 coat of primer & 2 coats of Emulsion

Ceiling : Finished with 2 coats of putty, 1 coat of primer & 2 coats of Emulsion

Exterior walls: Exterior faces of the building will be finished with 1 coat of primer & 2 coats of Emulsion paint with color as per architect design

Bathroom : Ceramic wall tile of size 300x600mm for a height of up to false ceiling will be finished with a coat of primer

Kitchen : Ceramic wall tile of size 300x600mm for a height of 600mm above the counter top finished level

Toilet ceiling : Grid type false ceiling

3. FLOOR FINISH

Living, Dining, Bedrooms & Kitchen : Vitrified tiles of size 600x1200mm

Bathroom : Anti-skid ceramic tiles of size 300x300mm

Balcony : Anti-skid ceramic tiles of size 600x600mm

Private open terrace (if applicable) : Pressed tiles finish

4. KITCHEN & DINING

Kitchen : Platform will be finished with granite slab at height of 800mm from the finished floor level

Electrical point : For chimney & water purifier

CP fitting : Kohler / American Standard /equivalent will be provided

Sink : Single bowl SS sink with drain board for 2BHK, 3BHK and 4BHK.

Single bowl SS sink without drain board for 1BHK units

Dining : Counter top washbasin will be provided wherever applicable.

5. BALCONY

Handrail : MS handrail as per architect's design

Cloth drying provision : Cloth drying Hanger in one of the balconies

6. BATHROOMS

CP & Sanitary fixture : Kohler / American standard /equivalent will be provided

All Bathrooms (Elite Series) : Floor mounted WC with cistern, Health faucet, Single lever diverter, Rain Shower and wall mount wash basin.

All Bathrooms (Superior Series) : Wall mounted WC with cistern, Health faucet, Single lever diverter, Rain Shower and counter mount wash basin.

7. JOINERY

DOORS

Main door : Good quality frame with double side veneer finish door of size 1050 x 2100mm with Decorative panel. Ironmongeries like Digital door lock, tower bolts, door viewer, safety latch, door stopper, etc.,

- Bedroom doors : Good quality skin door of size 900 X 2100mm with paint finish. Ironmongeries like Godrej or equivalent lock, door stopper, door bush, tower bolt, etc.,
- Bathroom doors : Good quality FRP door of size 750x2100mm with paint finish. Ironmongeries like thumb turn lock of Godrej/equivalent, door bush, etc.

WINDOWS

- Windows : Aluminium windows with sliding shutter see through plain glass
- French doors : Aluminium frame and doors with toughened glass
- Ventilators : Aluminium frame of fixed / open-able shutter for ODU access

8. ELECTRICAL POINTS

- Power Supply : 3 PHASE power supply connection
- Safety device : MCB & ELCB (Earth Leakage Circuit Breaker)
- Switches & sockets : Modular box & modular switches & sockets of good quality IS brand
- Wires : Fire Retardant Low Smoke (FRLS) copper wire of a good quality IS brand
- Mobile charging dock : Mobile charging dock provided in Living
- Hob Point : Point provided in the kitchen
- TV : Point in Living & any one bedroom and Provision in other bedrooms
- Telephone : Point in Living & any one bedroom
- Data : Point in Living & any one bedroom
- Split- air conditioner : Provision in Living / Dining and Point in all bedrooms
- Exhaust fan : Point will be given in all bathrooms
- Back-up (Elite series) : 600W for 3BHK, 500W for 2BHK & 400W for 1BHK
- Back-up (Superior series) : 750W for 4/3BHK, 600W for 2BHK & 500W for 1BHK

SPECIFICATIONS COMMON TO BUILDING COMPLEX

COMMON FEATURES:

1. Lift : Elevators of 8 passenger lifts will be provided as per requirement
2. Backup : 100% Power backup for common amenities such as Clubhouse, lifts, WTP, STP & selective common area lighting
3. Name board : Apartment owner name will be provided in ground floor
4. Lift facia : Granite / equivalent cladding at all levels
5. Lift Lobby : Granite flooring at ground level & tile flooring at other levels
6. Corridor : Tile flooring at all levels
7. Staircase floor : Granite flooring at ground level & Tile flooring at other levels
8. Staircase handrail : MS handrail with enamel paint finish in all floors
9. Terrace floor: Pressed tile flooring

OUTDOOR FEATURES:

1. Water storage : Centralised UG sump with WTP (Min. requirement as per water test report)
2. Rainwater harvesting : Rainwater harvesting at site
3. STP : Centralised Sewage Treatment plant
4. Intercom : Intercom will be provided
5. Safety : CCTV surveillance cameras will be provided all round the building at pivotal locations in ground level
6. Well defined walkway : Walkway spaces well defined as per landscape design intent
7. Security : Security booth will be provided at the entrance/exit
8. Compound wall : Site perimeter fenced by compound wall with entry gates for a height of 1800mm as per design intent
9. Landscape : Suitable landscape at appropriate places in the project as per design intent
10. Driveway: Convex mirror for safe turning in driveway in / out
11. External driveway : Interlocking paver block / equivalent flooring with demarcated driveway as per landscape design intent



LOCATION MAP



LOCATION ADVANTAGES

Hazen is located on the Bannerghatta Road and is well connected to Bengaluru's prime locations. The long stretch covers important locations such as JP Nagar, Jayanagar, BTM Layout NIMHANS and Dairy Circle. All you need are minutes not hours to travel from one place to another. Such ease of access and connectivity is a rarity in Bengaluru and that's what makes Hazen a prized possession. The development around will further contribute to the growth of the region and its value in the real estate market.

TRANSPORTATION

| | kms |
|--|------|
| 1 Upcoming Hulimavu Gate Metro Station | 2.6 |
| 2 Gottigere Bus Stop | 2.8 |
| 3 Bilekahalli Bus Stop | 4.7 |
| 4 Jayadeva Hospital Metro Station | 6.9 |
| 5 Majestic Bus Stand | 16.7 |
| 6 KSR Bengaluru City Junction | 16.8 |
| 7 Kempegowda International Airport Bengaluru | 48 |
| 8 Nice Road Junction | 2 |

EMPLOYMENT HUBS

| | |
|--------------------------------------|-----|
| 1 Divyasree Towers | 6.9 |
| 2 IBM Subrahmanya Arcade | 7.5 |
| 3 IBC Knowledge Park, SG Palya | 8.5 |
| 4 AMR Tech Park | 9 |
| 5 Global Tech Park, Langford Gardens | 13 |

SCHOOLS

| | |
|--|-----|
| 1 Vibgyor High School | 2.1 |
| 2 BGS National Public School, Hulimavu | 2.7 |
| 3 AECS Magnolia School | 2.9 |
| 4 Radcliffe School | 2.9 |
| 5 Narayana E Techno School, JP Nagar | 4.9 |
| 6 Presidency School, Bilekahalli | 6.5 |

COLLEGES

| | |
|--|------|
| 1 AECS Magnolia Maaruti PU and Nursing College | 0.65 |
| 2 Christ University Bannerghatta Road Campus, Hulimavu | 2.5 |
| 3 Aashvi Degree College | 2.5 |
| 4 T John College, Gottigere | 3.9 |
| 5 IIM-Bangalore, Bilekahalli | 4.5 |
| 6 AMC Engineering College | 4.7 |
| 7 BMS College of Commerce and Management, Basavangudi | 12.3 |
| 8 BMS College of Engineering, Basavangudi | 12.4 |

HOSPITALS

| | |
|--------------------------------------|-----|
| 1 Apollo Hospitals, Bannerghatta | 4.3 |
| 2 Fortis Hospital, Bannerghatta Road | 4.5 |
| 3 Jayadeva Hospital | 6.8 |
| 4 Sagar Hospitals, Jayanagar | 8.5 |
| 5 NIMHANS, Bangalore | 9.9 |

SHOPPING & ENTERTAINMENT

| | |
|------------------------|------|
| 1 Decathlon | 0.65 |
| 2 Royal Meenakshi Mall | 1.75 |
| 3 D Mart, Gottigere | 1.9 |
| 4 Vishal Mega mart | 4.3 |
| 5 Eagle Ridge Resort | 4.5 |

| | |
|------------------------------|-----|
| 6 Vega City Mall + PVR | 5.5 |
| 7 Gopalan Innovation Mall | 6.4 |
| 8 Bannerghatta National Park | 8.7 |

NEIGHBOURHOODS

| | |
|-----------------------|-----|
| 1 Hulimavu | 1.5 |
| 2 Kalena Agrahara | 1.6 |
| 3 Chandrasekarapura | 1.9 |
| 4 Kothnur | 2.5 |
| 5 Arekere | 3 |
| 6 Akshayanagar | 4 |
| 7 Anjanapura Township | 4.5 |
| 8 Bommanahalli | 6 |
| 9 Begur | 6 |
| 10 JP Nagar | 6.5 |
| 11 BTM Layout | 7 |
| 12 Jayanagar | 8 |
| 13 HSR Layout | 8 |
| 14 Electronic City | 11 |

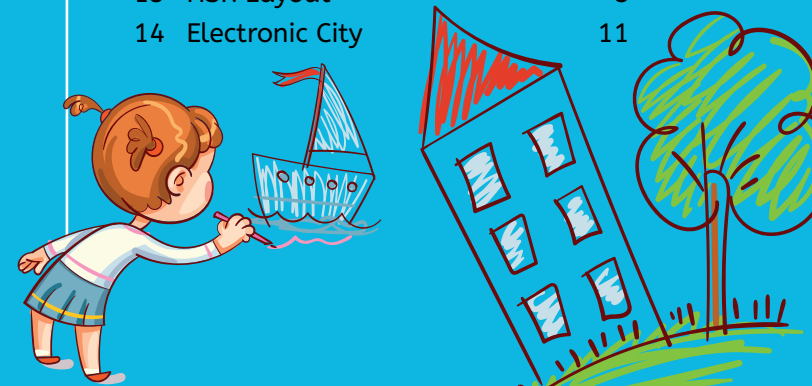



PAYMENT SCHEDULE

| | |
|---|-------|
| Booking Advance | 5.0% |
| On Agreement of Sale | 10.0% |
| 25 Days from the date of Agreement | 30.0% |
| Commencement of Foundation | 10.0% |
| Commencement of Basement Roof | 7.5% |
| Commencement of Ground Floor Roof | 7.5% |
| Commencement of 1st Floor Roof | 7.5% |
| Commencement of 2nd Floor Roof | 7.5% |
| Commencement of 3rd Floor Roof | 5.0% |
| Commencement of 4th floor Roof | 5.0% |
| Completion of flooring of Respective Unit | 2.5% |
| Handing over | 2.5% |



AWARDS



Best Residential Project (South India)
2018 - 2019 Casagrand Crescendo
CNBC Awaaz Real Estate Awards



Best TV Commercial Casagrand
'Superior Homes Assured' IndIAA
Regional (Tamil) Awards



Largest Project of the Year - 2018
Casagrand Luxus TOI



Best Affordable Housing Project of the Year
Casagrand NexTown CMO Global



Excellence in Delivery - 2018
ET Now



Developer of the Year 2018-2019
Realty Fact & Quickr



Distinguished Design Awards 2017
Casagrand ECR14



CSR Initiative of the Year - 2018
ET Now



Luxury Villa Project of the Year -
South Region Casagrand Esmeralda
11th Estate Annual Awards



Best Affordable Housing Project of
the Year - ROTN Casagrand
NexTown RESA



Best Luxury Residential Project of the Year Casagrand ECR14

Signature Zee Business National Real Estate Leadership
Congress and Awards 2019



Luxury Project of the Year - 2015-16

Casagrand Aldea Realty Fact



Best Real Estate Company of Tamil Nadu at
Times Business Awards 2020 (Organized by
The Times of India)



CASAGRANT Firstcity has been conferred with 'Luxurious
Affordable Housing Project' at
GLOBAL REAL ESTATE CONGRESS



Buddy Neighbour Scheme

Refer & Earn

We know you value partnerships just as much as we do. Stand a chance to earn great rewards by referring your friends, colleagues or family to a Casagrand home.

Because no one knows our homes better than you.

To refer, call **98844 59522**
referral@casagrand.co.in | www.cgreferral.com

GET ASSURED RENT ON YOUR CASAGRANT PROPERTY.

CASAGRANT RENT ASSURE

Call **98841 99957**
www.cgrentassure.com

SELLASSURE
selling casagrand home made easy

WE'LL HELP YOU SELL.

Casagrand introduces SELLASSURE, a hassle-free resale solution for Casagrand Home Buyers. Understanding our customers needs, we have enabled a one stop solution which creates the right exposure to listed properties, generates refined leads and ensures seamless closures.

Contact us at **99622 09500**
www.cgsellassure.com | sellassure@casagrand.co.in

DOMYHOME
THE ART OF INTERIORS
 Casa Interior Studio Private Limited

HOME INTERIORS FROM THE HOUSE OF CASAGRANT

YOU DREAM. WE DESIGN.

Your home is more than just bricks and cement. It is a reflection of your personality and charm. Do My Home is there for all your home transformation needs.

We specialize in solutions such as Wood work, Electrical fittings, Curtains, Bathroom accessories, Painting, False ceiling, Decorative flooring and spanning over 3025 products.

10 years warranty on cabinetry.

98848 44496 enquiryblr@domyhome.in
www.domyhome.in

RERA : PRM/KA/RERA/1251/310/PR/220722/005099 | www.rera.karnataka.gov.in

CASAGRANT

building aspirations

CORPORATE OFFICE:

NPL Devi, New No. 111, Old No. 59, LB Road,
 Thiruvananthapuram, Chennai - 600 041.
 Ph: +91-44 4411 1111
 Mob: 8939977577 Fax: +91-44 4315 0512

COIMBATORE OFFICE:

Sri Dwaraka, No. 1-A, B.R. Nagar Main Road
 Singanailur Post, Coimbatore - 641 005
 Ph: +91-72993 70001

BENGALURU OFFICE:

Salma Bizhouse, 34/1, 4th Floor,
 Manee Avenue Road, Opp. Lakeside Hospital,
 Ulsoor Lake, Bengaluru - 560 042.
 Ph: +91-80 4666 8666

DUBAI OFFICE:

4th Floor, Block-B, Business Village, Dubai
 United Arab Emirates, PO Box. 183125
 Ph: +971-565302759

Disclaimer: Whilst reasonable care has been taken in preparing the brochure and constructing the model and sales gallery show flat (the materials), the developer and its agents shall not be held responsible for any inaccuracies in their contents or between the materials and the actual unit. All statements, literature and depictions in the materials are not to be regarded as a statement or representations of the fact. Visual representation such as layout plans, finishes, illustrations, pictures, photographs and drawings contained in the materials are artists' impressions only and not representations of fact. Such materials are for general guidance only and should not be relied upon as accurately describing any specific matter. All information, specifications, plans and visual representations contained in the materials are subject to changes from time to time by the developer and/or the competent authorities and shall not form part of the offer or contract. The sales and purchase agreement shall form the entire agreement between the developer and the purchaser and shall in no way be modified by any statement, representations or promises (whether or not contained in the materials and/or made by the developer or the agent) made. No part of the materials shall constitute a representation or warranty. Measurements given for kitchen includes utility area also. All measurements for all rooms are in feet, inches and metres.